

TYPICAL GLASS BALUSTRADING
ELEVATION CANTERBURY SUITE
SCALE N.T.S.

<p>Customer Name Nu-Lite Canterbury Suite</p>	<p>Drawn by T.C.</p>	<p>Checked by</p>	<p>Approved by - date</p>	<p>Date 12/11/07</p>	<p>Scale N.T.S.</p>
<p>Application Commercial Aluminium Balustrading detail</p>	<p>Part Number</p>		<p>Nu-Lite Balustrading 6 Nicholas Drive Dandenong Sth 3175 Ph. 03 9706 6766 Fax. 03 9706 4994 © Nu-Lite Balustrading 2004</p>		
<p>Notes</p>	<p>Edition A</p>	<p>Sheet</p>			

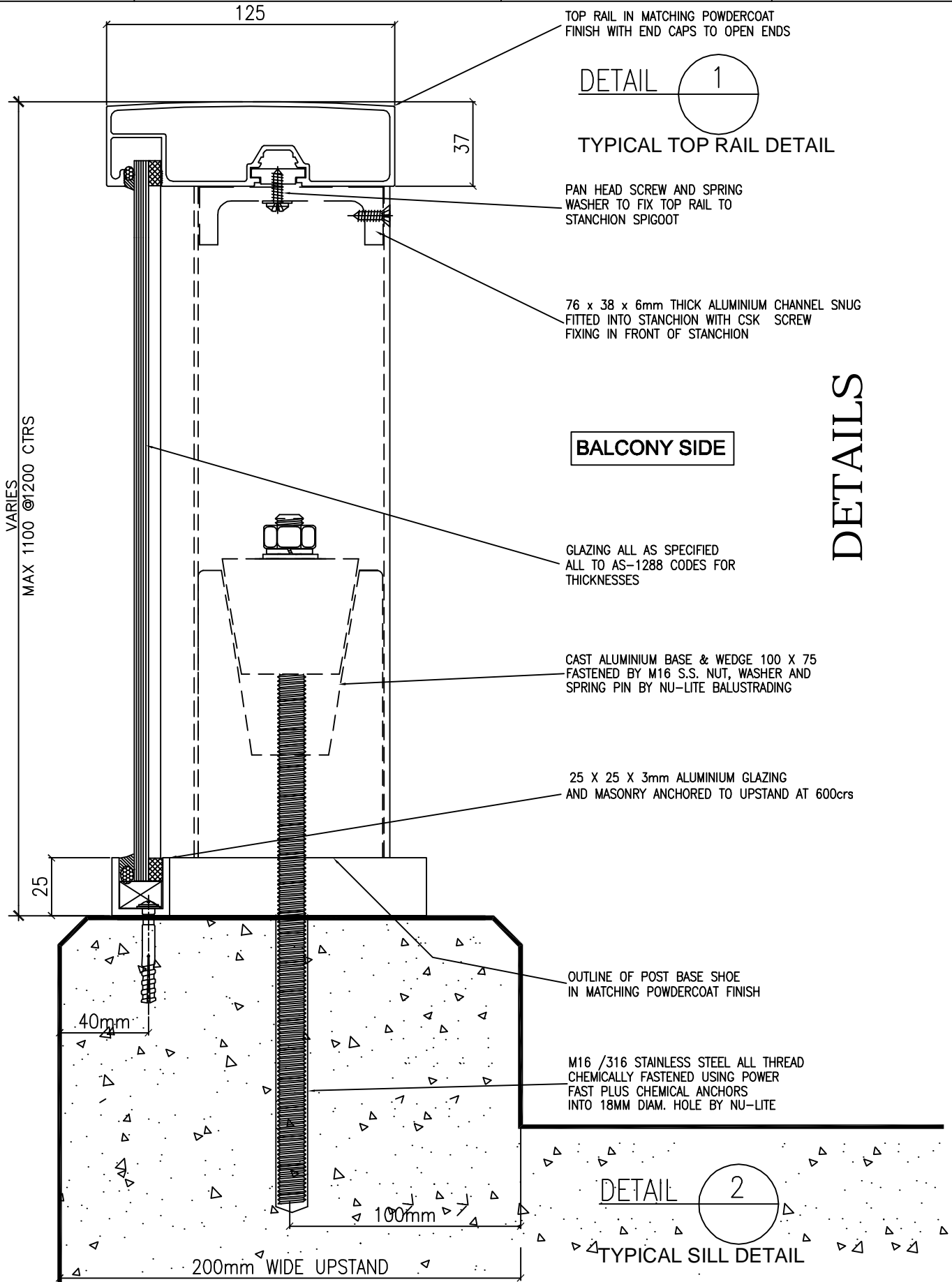

DETAIL 1

TYPICAL TOP RAIL DETAIL

PAN HEAD SCREW AND SPRING WASHER TO FIX TOP RAIL TO STANCHION SPIGOOT

76 x 38 x 6mm THICK ALUMINIUM CHANNEL SNUG FITTED INTO STANCHION WITH CSK SCREW FIXING IN FRONT OF STANCHION

BALCONY SIDE

GLAZING ALL AS SPECIFIED ALL TO AS-1288 CODES FOR THICKNESSES

CAST ALUMINIUM BASE & WEDGE 100 X 75 FASTENED BY M16 S.S. NUT, WASHER AND SPRING PIN BY NU-LITE BALUSTRADING

25 X 25 X 3mm ALUMINIUM GLAZING AND MASONRY ANCHORED TO UPSTAND AT 600crs

OUTLINE OF POST BASE SHOE IN MATCHING POWDERCOAT FINISH

M16 /316 STAINLESS STEEL ALL THREAD CHEMICALLY FASTENED USING POWER FAST PLUS CHEMICAL ANCHORS INTO 18MM DIAM. HOLE BY NU-LITE

DETAIL 2

TYPICAL SILL DETAIL

DETAILS

Customer Name	Drawn by	Checked by	Approved by - date	Date	Scale
Nu-Lite Canterbury Suite	T.C.			12/11/07	N.T.S.
Application	Part Number		Nu-Lite Balustrading		
Commercial Aluminium Balustrading detail			6 Nicholas Drive Dandenong Sth 3175		
Notes	Edition	Sheet	Ph. 03 9706 6766 Fax. 03 9706 4994		
	A		© Nu-Lite Balustrading 2004		

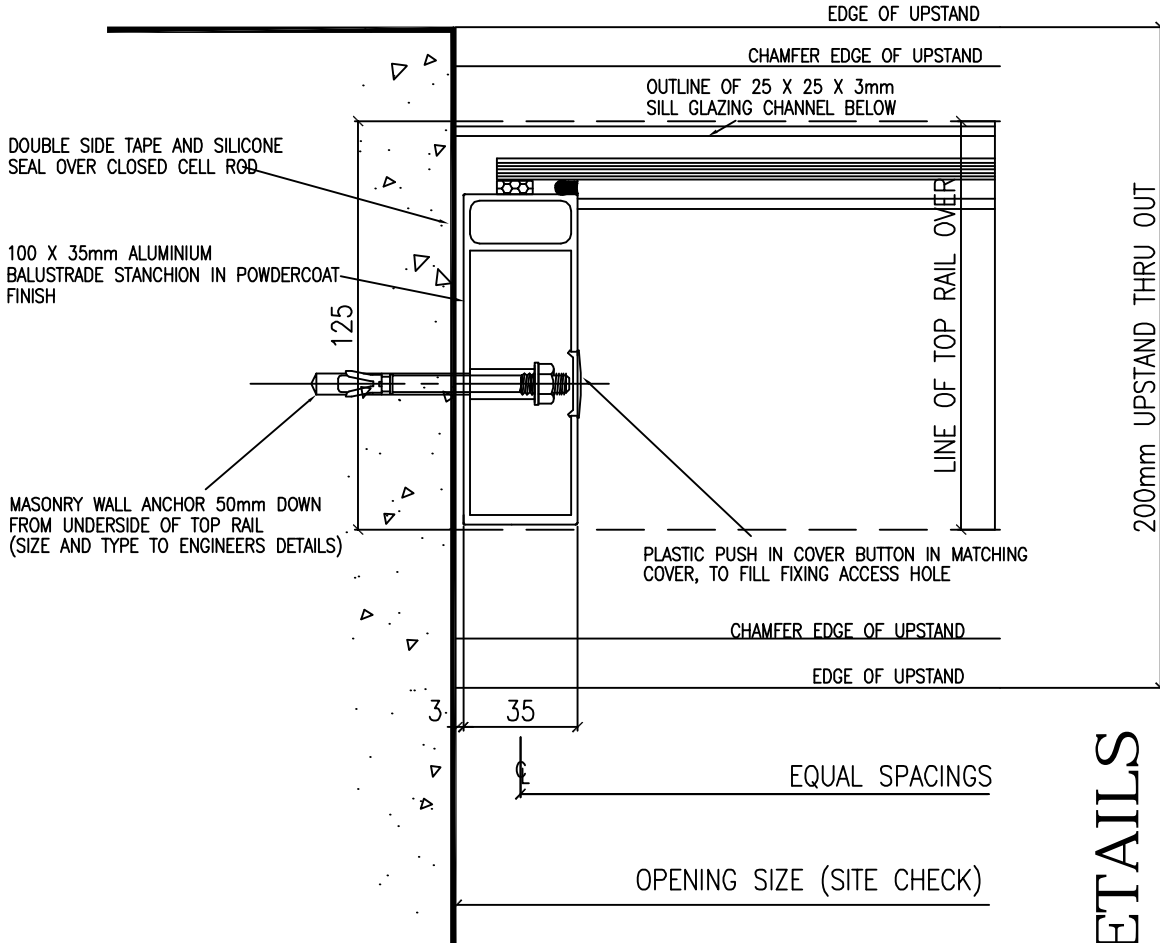

BALCONY SIDE

DETAILS

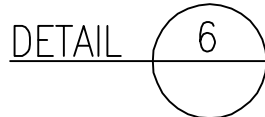
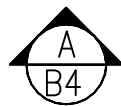

DETAIL 6
TYPICAL JAMB DETAIL
MAY BE MIRRORED TO SUIT

<p>Customer Name Nu-Lite Canterbury Suite</p>	<p>Drawn by T.C.</p>	<p>Checked by</p>	<p>Approved by - date</p>	<p>Date 12/11/07</p>	<p>Scale N.T.S.</p>
<p>Application Commercial Aluminium Balustrading detail</p>	<p>Part Number</p>		<p>Nu-Lite Balustrading 6 Nicholas Drive Dandenong Sth 3175 Ph. 03 9706 6766 Fax. 03 9706 4994 © Nu-Lite Balustrading 2004</p>		
<p>Notes</p>	<p>Edition A</p>	<p>Sheet</p>			

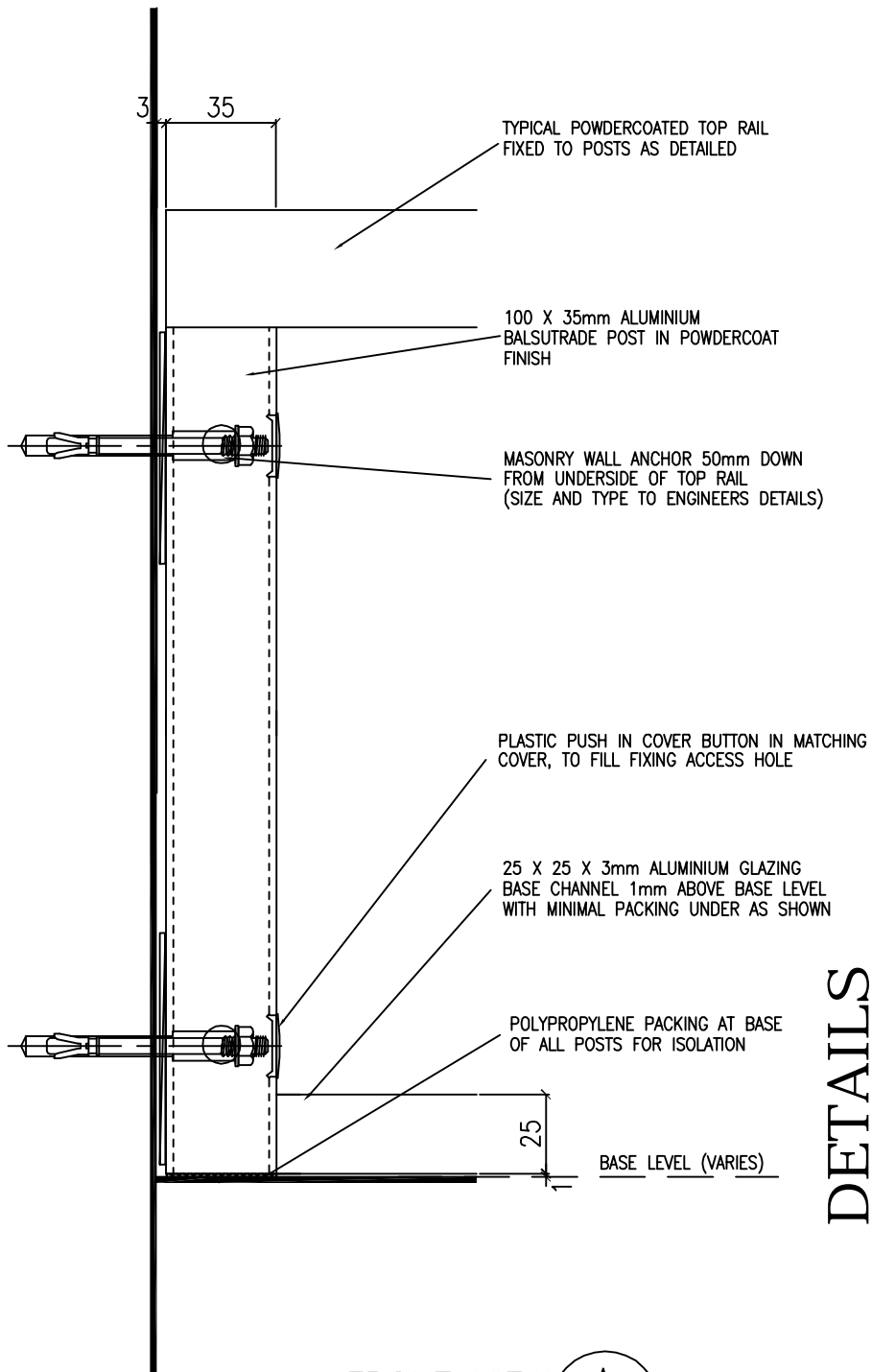

DETAILS

FRONT VIEW (A)
MAY BE MIRRORED TO SUIT

<p>Customer Name Nu-Lite Canterbury Suite</p>	<p>Drawn by T.C.</p>	<p>Checked by</p>	<p>Approved by - date</p>	<p>Date 12/11/07</p>	<p>Scale N.T.S.</p>
<p>Application Commercial Aluminium Balustrading detail</p>	<p>Part Number</p>			<p>Nu-Lite Balustrading 6 Nicholas Drive Dandenong Sth 3175 Ph. 03 9706 6766 Fax. 03 9706 4994 © Nu-Lite Balustrading 2004</p>	
<p>Notes</p>	<p>Edition A</p>	<p>Sheet</p>			

TYPICALLY A 200mm UPSTAND APPLIES
HOWEVER IN SOMES CASES THIS MAY
VARY ALTHOUGH THE BALUSTRADE DETAIL
REMAINS THE SAME THROUGH-OUT

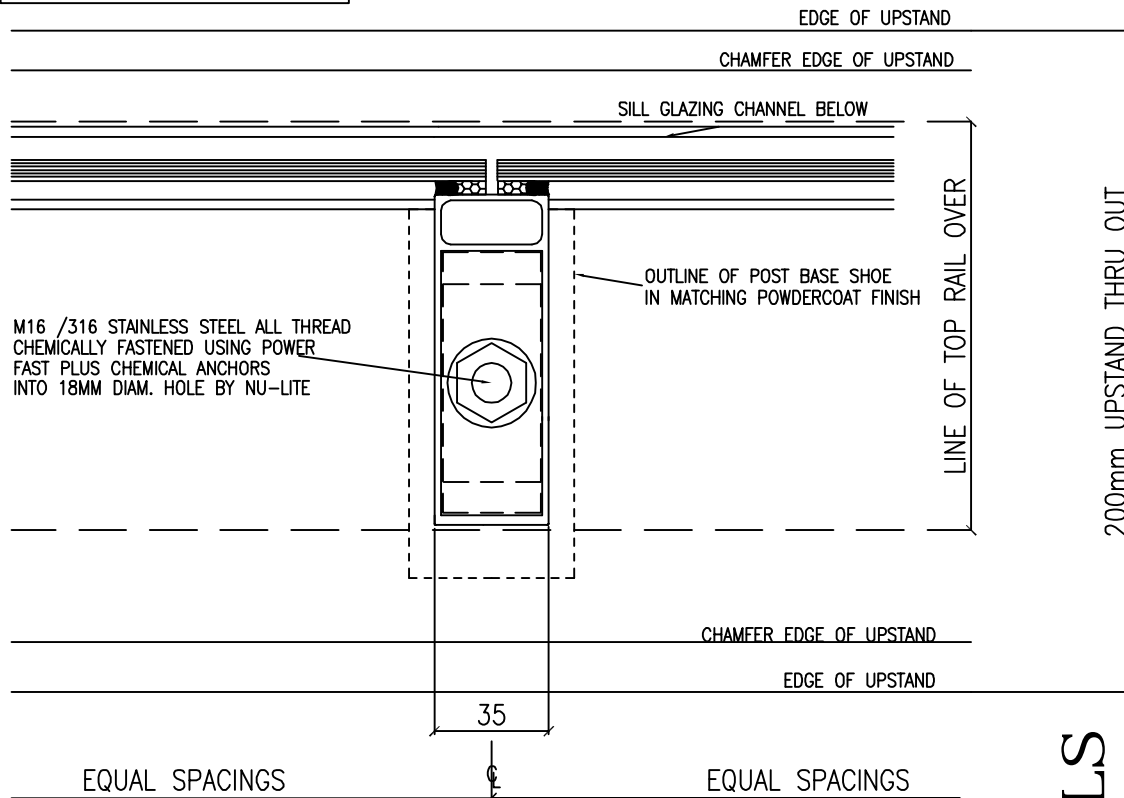

BALCONY SIDE

DETAILS



TYPICAL STANCHION DETAIL
MAY BE MIRRORED TO SUIT

<p>Customer Name Nu-Lite Canterbury Suite</p>	<p>Drawn by T.C.</p>	<p>Checked by</p>	<p>Approved by - date</p>	<p>Date 12/11/07</p>	<p>Scale N.T.S.</p>
<p>Application Commercial Aluminium Balustrading detail</p>	<p>Part Number</p>			<p>Nu-Lite Balustrading 6 Nicholas Drive Dandenong Sth 3175 Ph. 03 9706 6766 Fax. 03 9706 4994 © Nu-Lite Balustrading 2004</p>	
<p>Notes</p>	<p>Edition A</p>	<p>Sheet</p>			